

Satellite Meeting of ICN 2014 in Sydney
Recent and Future Trends in Neuroendocrinology
- from Asia and Oceania to Global -

16th (Saturday) August, 2014
Novotel Sydney Manly Pacific

Organizer:

Yoichi Ueta (University of Occupational and Environmental Health (UOEH), Japan)

Sponsor:

Japan Neuroendocrine Society

Satellite Meeting of ICN 2014 in Sydney
Recent and Future Trends in Neuroendocrinology
- from Asia and Oceania to Global -
sponsored by Japan Neuroendocrine Society

16th (Saturday) August, 2014
Novotel Sydney Manly Pacific



Level 1 – Conference Floor

VIEW TO MANLY BEACH

Not to scale

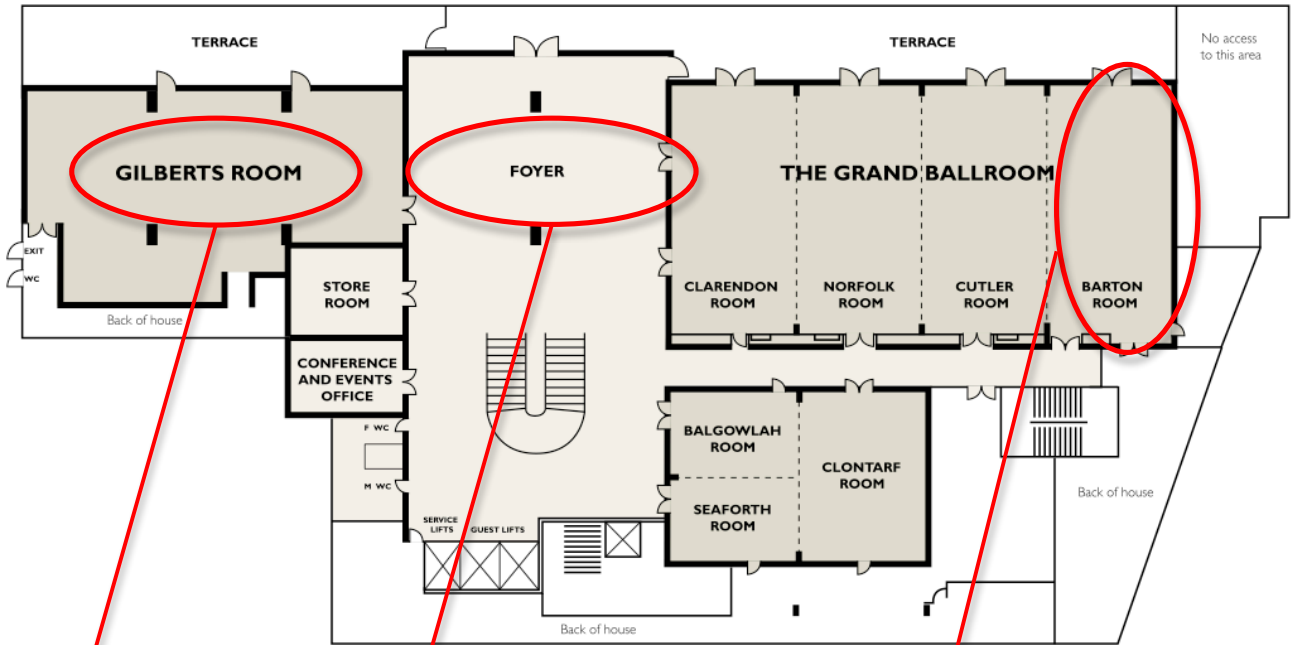

Dinner

Lunch

Meeting room

Speakers and Discussants (alphabetically)

Hiroshi Arima (Nagoya University, Japan)
Xue-Qun Chen (Zhejiang University, China)
Iain Clarke (Monash University, Australia)
Yukari Date (Miyazaki University, Japan)
Ji-Zeng Du (Zhejiang University, China)
Anne Duittoz (University of Tours, France)
Valery Grinevich (University of Heidelberg, Germany)
Daisuke Hagiwara (Nagoya University, Japan)
Hirofumi Hashimoto (UOEH, Japan)
Belinda Henry (Monash University, Australia)
Norio Iijima (Nippon Medical University, Japan)
Gareth Leng (University of Edinburgh, UK)
Kenichi Matsuda (Kyoto Prefectural University of Medicine, Japan)
Mayumi Nishi (Nara Medical University, Japan)
Sonoko Ogawa (Tsukuba University, Japan)
Brian Oldfield (Monash University, Australia)
Tatsushi Onaka (Jichi Medical University, Japan)
Hitoshi Ozawa (Nippon Medical University, Japan)
Quentin Pittman (Calgary University, Canada)
Ishwar Parhar (Monash University, Malaysia)
Akira Shimatsu (National Hospital Organization Kyoto Medical Center, Japan)
Stephanie Simonds (Monash University, Australia)
Tomoko Soga (Monash University, Malaysia)
Shinji Tsukahara (Saitama University, Japan)
Yoichi Ueta (UOEH, Japan)
Susan Wray (NINDS, NIH, USA)

Program

8:20 **Opening Remarks:** Yoichi Ueta (UOEH, Japan)

8:25-10:05 **Session 1** **Reproductive Neuroendocrinology**

Chairs: Sonoko Ogawa, Ishwar Parhar

S1-1 **Influence of early life stress on gonadotropin-inhibitory hormone neurons**

Tomoko Soga (Monash University, Malaysia)

S1-2 **Sex steroid actions on the formation of morphological sex difference in the rodent brain**

Shinji Tsukahara (Saitama University, Japan)

S1-3 **Is gonadotropin-inhibitory hormone (GnIH) inhibitory in fish?**

Ishwar Parhar (Monash University, Malaysia)

S1-4 **Role of two types of estrogen receptors in life-long action of gonadal steroids in the regulation of social behavior**

Sonoko Ogawa (University of Tsukuba, Japan)

10:05-10:20 **Coffee Break 1**

10:20-12:00 **Session 2** **Interactions Between Neuroendocrine Neurones and Glia**

Chair: Gareth Leng (University of Edinburgh, UK)

S2-1 **Early immune experience: implications for adult behavioral and neuroendocrine responses**

Quentin Pittman (Calgary University, Canada)

S2-2 **Interaction between CRF neuron and glia induces cerebral edema under acute severe hypoxia**

Ji-Zeng Du (Zhejiang University, China)

S2-3 **Does lineage of GnRH-1 neuron equate to functional differences?**

Susan Wray (NINDS, NIH, USA)

S2-4 **Glial gap-junction mediated regulation of GnRH neurons network activity**

Anne Duittoz (University of Tours, France)

12:00-13:30 **Lunch (Foyer)**

13:30-15:10 Session 3 Feeding and Metabolism

Chair: Iain Clarke (Monash University, Australia)

S3-1 The neuroendocrinology of BAT function - lessons from rodent models

Brian Oldfield (Monash University, Australia)

S3-2 Neuroendocrine determinants of the predisposition to obesity: Cortisol responsiveness as a marker for propensity to become obese

Belinda Henry (Monash University, Australia)

S3-3 Possible interaction of GLP-1 and leptin or CCK and leptin on feeding reduction via AMP-activated protein kinase

Yukari Date (Miyazaki University, Japan)

S3-4 The pressure of obesity

Stephanie Simonds (Monash University, Australia)

15:10-15:25 Coffee Break 2

15:25-17:30 Session 4 Neurohypophyseal Hormones

Chairs: Hiroshi Arima (Nagoya University, Japan)

Tatsushi Onaka (Jichi Medical University, Japan)

S4-1 Viral vectors for neuroendocrinology

Valery Grinevich (University of Heidelberg, Germany)

S4-2 Mechanisms underlying autophagy-associated cell death of vasopressin neurons in a mouse model of familial neurohypophysial diabetes insipidus

Daisuke Hagiwara (Nagoya University, Japan)

S4-3 Estrogen receptor α in the brain: genetic and epigenetic approaches

Kenichi Matsuda (Kyoto Prefectural University of Medicine, Japan)

S4-4 *In vivo* and real-time monitoring of the deep brain neurons in free moving animals by laser apparatus with optical fiber

Norio Iijima (Nippon Medical University, Japan)

S4-5 Lesions of vasopressin neurons by use of vasopressin-DTR transgenic rats

Tatsushi Onaka (Jichi Medical University, Japan)

17:30 Closing Remarks: Iain Clarke (Monash University, Australia)

18:00 Dinner (Gilberts room)